

AE310 Outdoor Siren



Description

The AE310 is a robust all-weather outdoor siren for operational warning or auxiliary alarming for hoist machinery, construction and port machinery. This fixture can also be applied for mine facilities, chemical industries, and marine or vessels, etc.

Features

- Powerful 104 - 116dB
- Light-weight high-impact aluminium body, excellent corrosion resistance
- Waterproof and dustproof performance, meeting IP65 ingress protection
- Wall-mounted or plane-mounted options to meet various installation requirements
- Industrial grade digital and audio chip to guarantee the high stability and EMI
- 5 tone or 16 tone modes

Applications

Construction, hoist and port machinery, chemical industries, mine sites

Tech Specs

| | |
|-----------------------|---|
| Decibels | 104 ~ 116dB |
| Voltage | 36V AC, 110V AC, 220V AC, 380V AC 24V DC (customised) |
| Wattage | 20W |
| Tones | Mode 1: A, B, E, D, whistle (5 tones) Mode 2: 16 tones |
| IP Rating | IP65 |
| Operating Temperature | -30°C to +70°C |
| Humidity | 10% ~ 95% (no coagulation) |
| Housing | Aluminium |
| Colour | Red (body), black (speaker) |
| Weight | 4.41 lbs (2kg) |
| Dimensions (H, W, L) | 4.7x6.4x7.6" (120x162x192mm) - for AE310U |

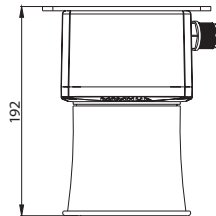
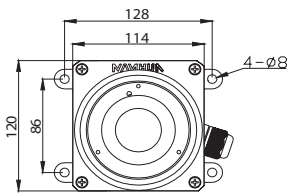

AE310U - Wall-mounted version

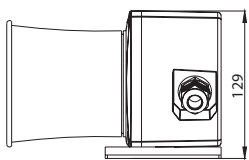
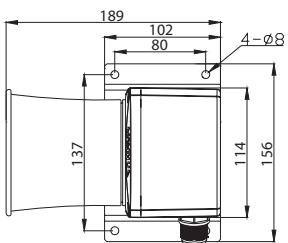

AE310P - Plane-mounted version

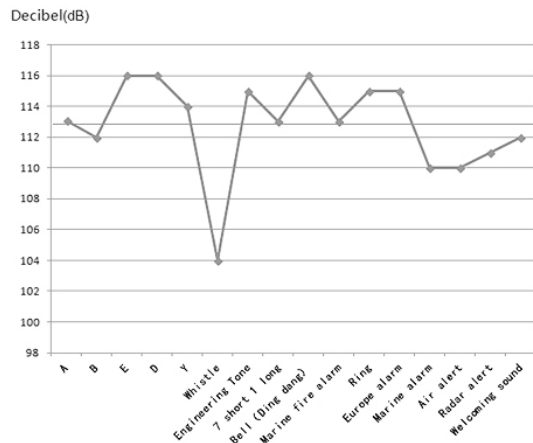

Decibel and Tone Corresponding Curve

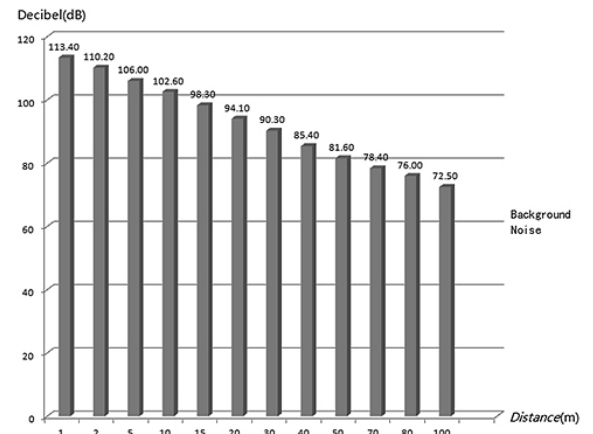

Decibel and Distance Corresponding Curve

Authorised Importer and Master Distributor

